

INSTALLATION INSTRUCTIONS

Failure to follow these instructions can severely shorten the life of this part and may void the part's warranty.

Installation Process

1. The original Cap design had a flange that fit into the module slot, leaving the outside flange of the Module exposed.
2. This new design has an added lip and arches which allows the Module to be covered by the Cap and rest within the Cap. Properly assembled the Module flange is enveloped by the Cap's channel groove creating a better fit against moisture and dirt.
3. CAUTION: Do not remove any material from the arches. When replacing the original design with this Cap be sure to correctly align the Module. Forcing the Cap on the Module will cause damage to the distributor base, Cap, and Module.
4. On installations where the distributor is hidden from view, be sure the Cap is correctly mounted to the distributor before tightening.

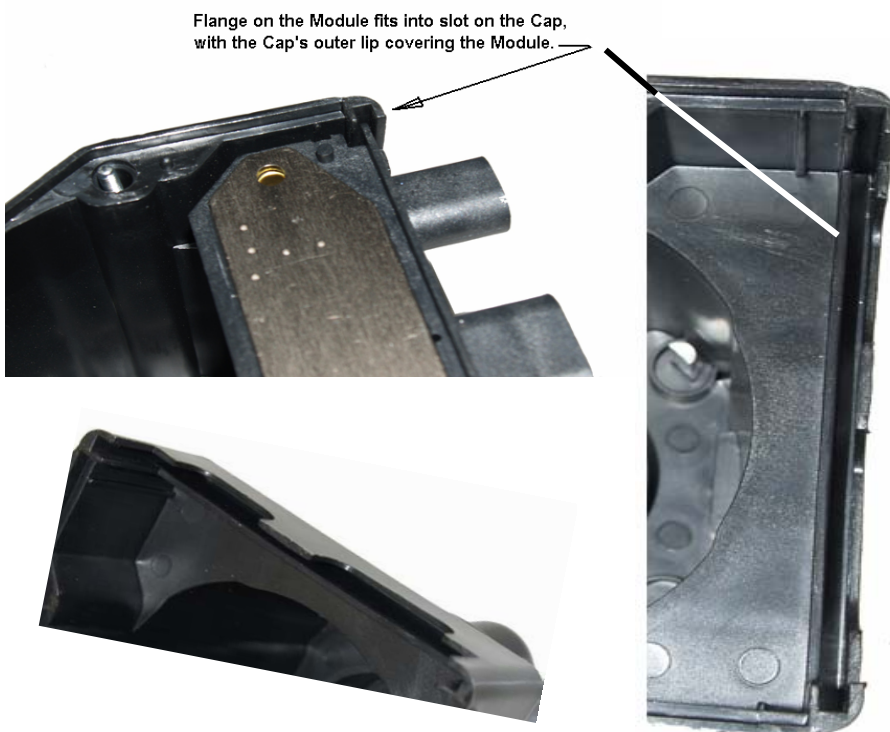

Models Covered:
4943